



Pre-/Post-GeoVet Workshops

October 2019

Gladys Valley Hall, UC Davis

Pre- and Post-conference Workshops

Workshops Venue: Gladys Valley Hall – School of Veterinary Medicine



GENERAL INFORMATION FOR WORKSHOP ORGANIZERS AND PARTICIPANTS

- The pre-conference and post-conference workshops will take place in **Gladys Valley Hall** (see location in next slides)
- Instructors, please check the room location and equipment (last slides) that is available in each room assigned to your workshop and let us know if you need something else. Remember that no computers are available for the workshop instructor or the participants, each instructor/participant has to bring their own computer.
- Make sure to contact participants in your workshop to provide general guidelines/instructions for pre-installation of software or readings needed before the workshop starts.



Pre- and Post-conference Workshops

Workshops Venue: Gladys Valley Hall – School of Veterinary Medicine



GENERAL INFORMATION FOR WORKSHOP ORGANIZERS AND PARTICIPANTS

- One member of the GeoVet Organizing team will be there everyday to help setting up your computer/presentation and assist you with anything you may need. You will be able to communicate in real time using Whova in case something is needed in your room.
- Coffee breaks (at 10:30am and 3:00pm) and lunch (at 12pm) will be provided in the designated rooms (see next slides). You are free to take your coffee/lunch to the hall or enjoy the outside patio
- If you want to provide certificates to the workshop participants you can either print them and bring them before the workshop or we can print them for you in certificate paper similar to the one in this figure (at a cost \$5 per participant)

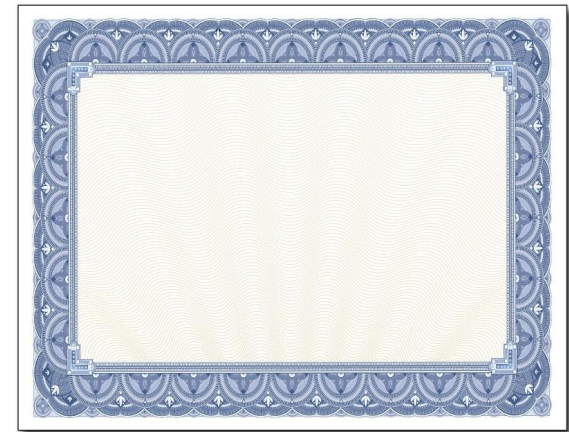

Workshops Venue: Gladys Valley Hall – School of Veterinary Medicine



-

<https://jump.com>

Pre- and Post-conference Workshops

Workshops Venue: Gladys Valley Hall – School of Veterinary Medicine



HOW TO GET THERE

- **By car:**
 - You can park in the visitor parking lots located near Valley Hall (marked with "P" in this figure)
 - Remember that visitor parking costs \$9 per day and you will need to display your ticket in the dashboard of your car.
 - More details here: <https://campusmap.ucdavis.edu>



Workshops Venue: Gladys Valley Hall – School of Veterinary Medicine



- The screenshot displays the Google Maps interface for a walking route from Gladys Valley Hall, Davis, CA 95616 to Hyatt Place UC Davis, 173 Old Davis Rd. The left sidebar shows the starting point, destination, and three route options, all estimated at 23 minutes and 1.2 miles. The map view shows the University of California, Davis campus, with the selected route highlighted in blue. Key landmarks include the University of California, Davis, Gladys Valley Hall, Hyatt Place UC Davis, and various campus buildings and parking lots.

ROOM LOCATION

Valley Hall

1 2

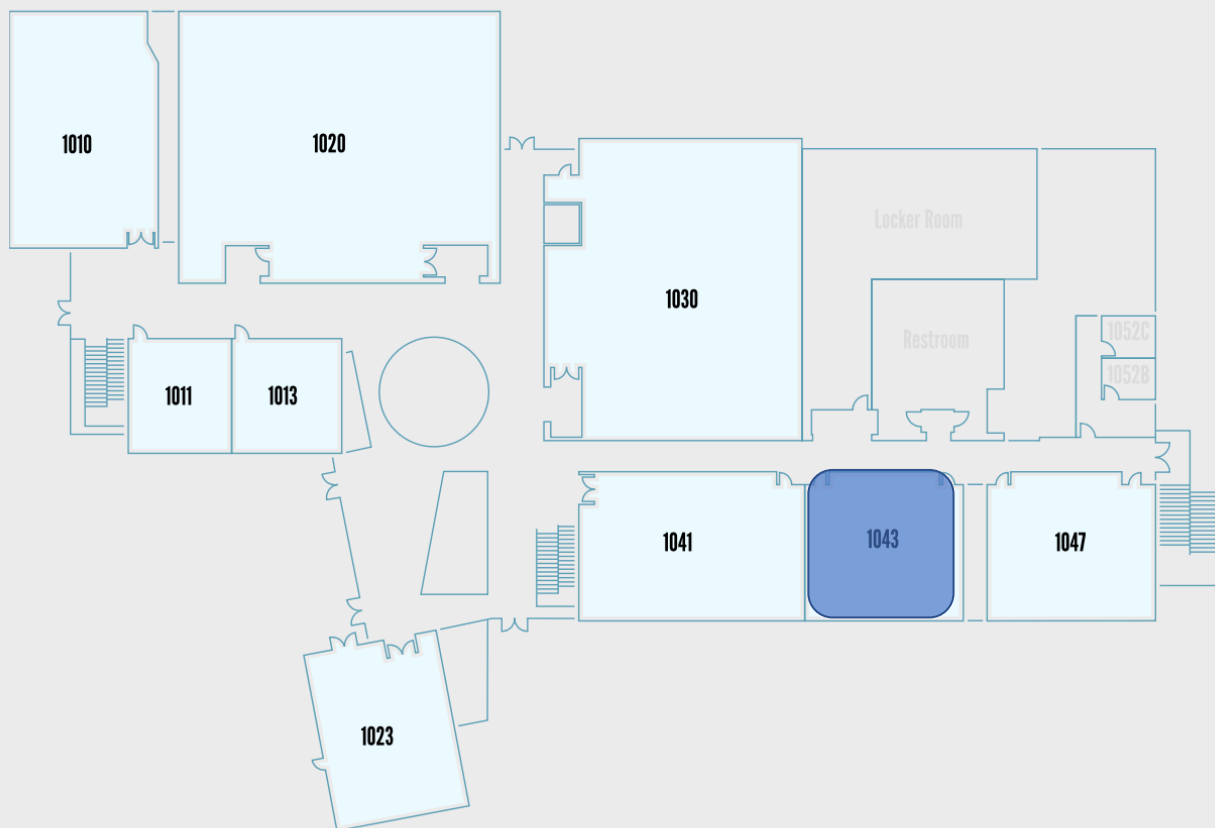

VALLEY 1043 (50)

- ▶ Video projector/flat screen display
- ▶ Macintosh Computer (built-in)
- ▶ Windows computer (built-in)
- ▶ USB input
- ▶ Laptop input
- ▶ Adobe Connect ready
- ▶ Microphone system (wireless)
- ▶ Podcast recording
- ▶ Wi-Fi
- ▶ Wired Ethernet
- ▶ Whiteboard
- ▶ Mediasite Recorder

WK1

- Monday (Oct 7th)
- Room 1043

1 – Introduction to GIS & Map Making with QGIS (1 day)

WK2

- Sunday (Oct 6th)
- Room 1011

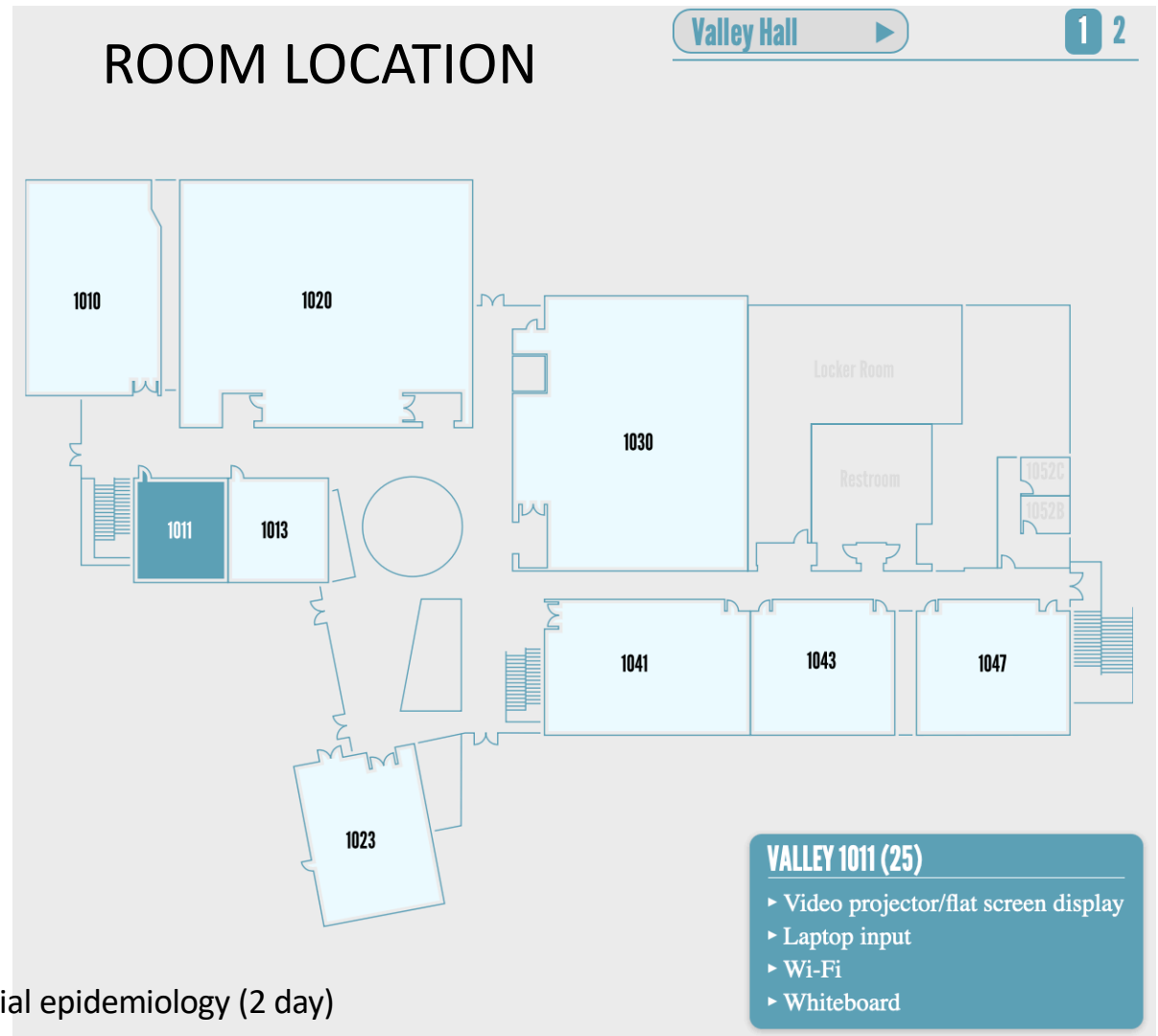

2 – The application of molecular tools to spatial epidemiology (2 day)

WK2

- Monday (Oct 7th)
- Room 2052

ROOM LOCATION

Valley Hall

1 2

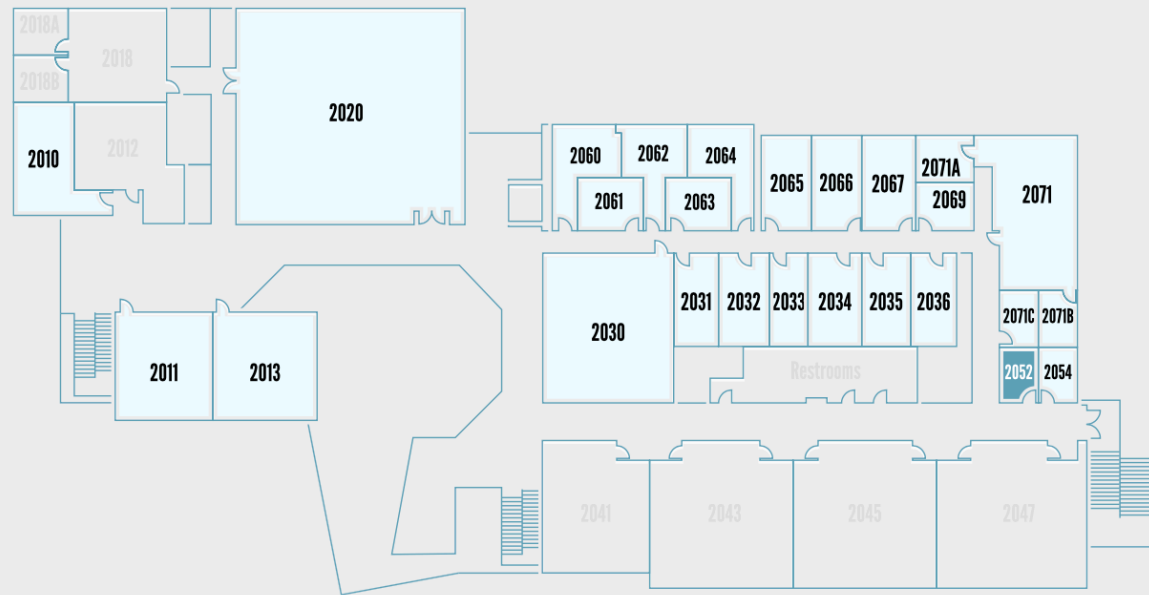

VALLEY 2052 (10)

- Video projector/flat screen display
- Laptop input
- Wi-Fi
- Whiteboard

2 – The application of molecular tools to spatial epidemiology (2 day)

WK3

- Sunday (Oct 6th)
- Room 1013

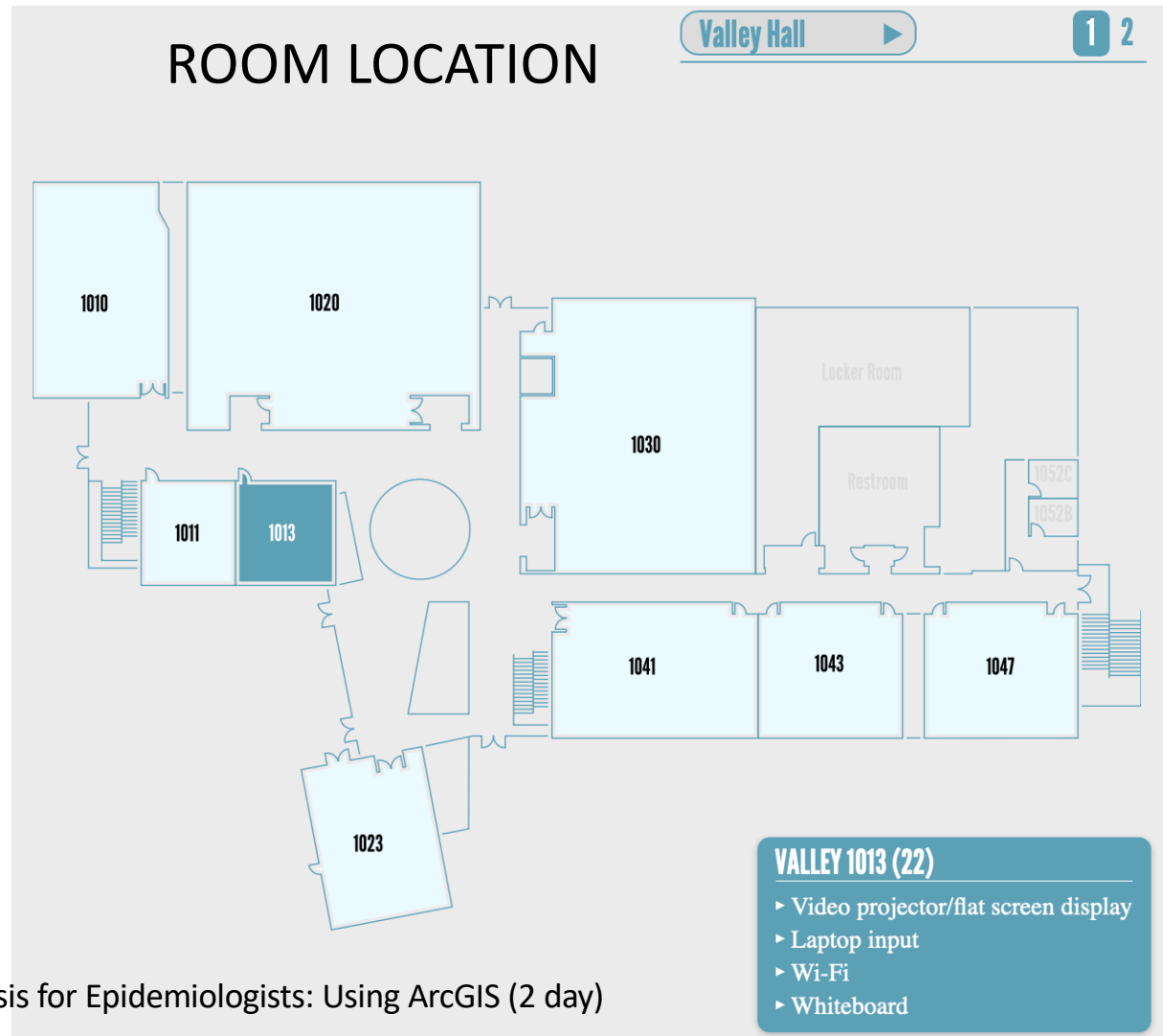

3 – Introduction to GIS and Spatial Analysis for Epidemiologists: Using ArcGIS (2 day)

WK3

- Monday (Oct 7th)
- Room 2054

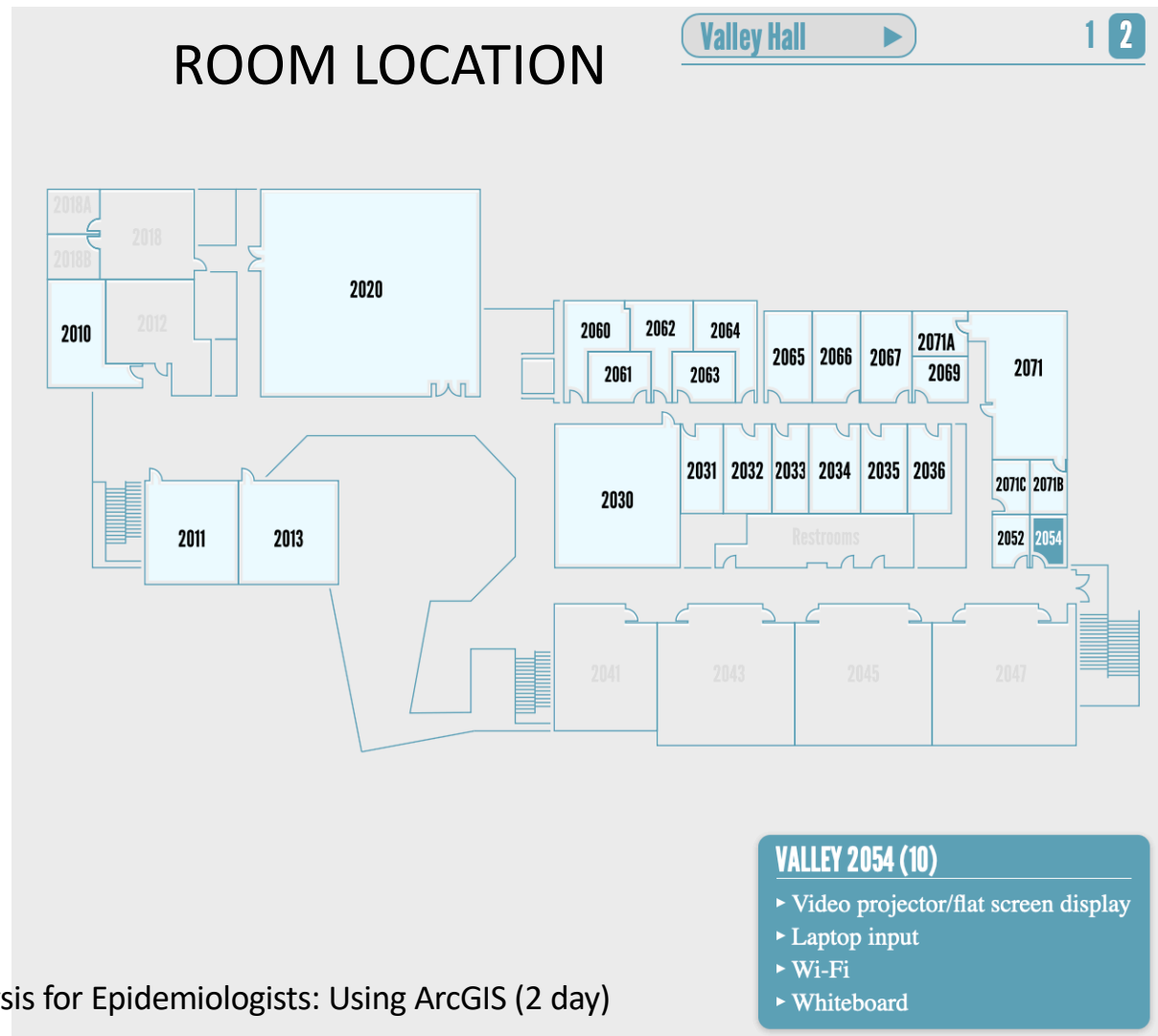

3 – Introduction to GIS and Spatial Analysis for Epidemiologists: Using ArcGIS (2 day)

WK4

- Monday (Oct 7th)
- Room 2071c

ROOM LOCATION

Valley Hall

1 2

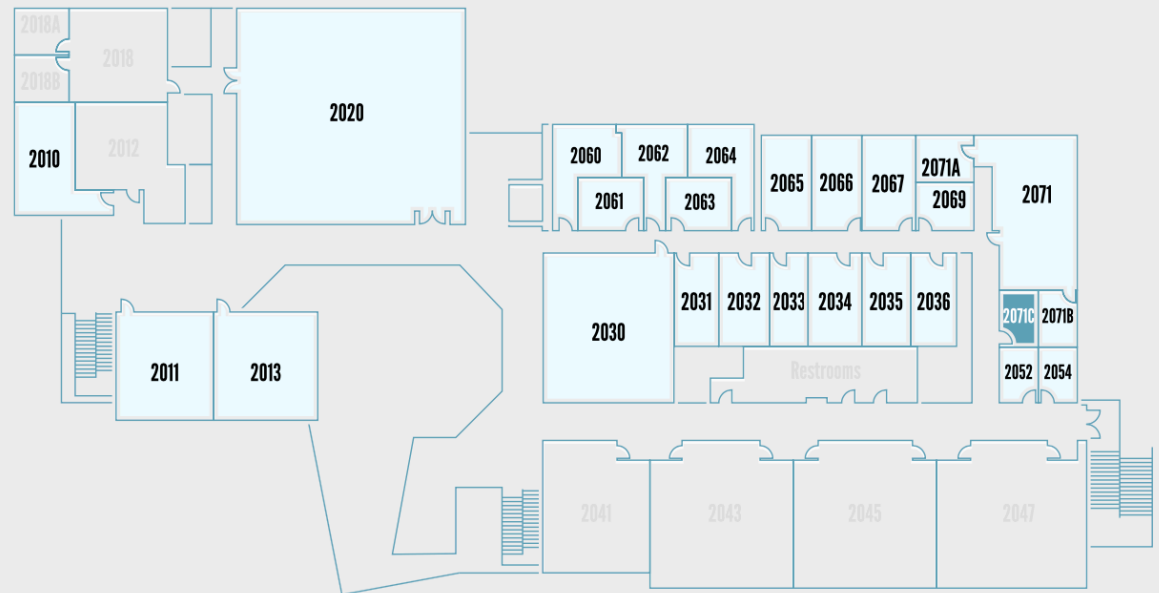

VALLEY 2071C (10)

- ▶ Video projector/flat screen display
- ▶ Laptop input
- ▶ Wi-Fi
- ▶ Whiteboard

4 – Spatio-temporal analysis of movement networks (1 day)

WK5

- Friday & Saturday (Oct 11-12th)
- Room 2013

ROOM LOCATION

Valley Hall

1 2

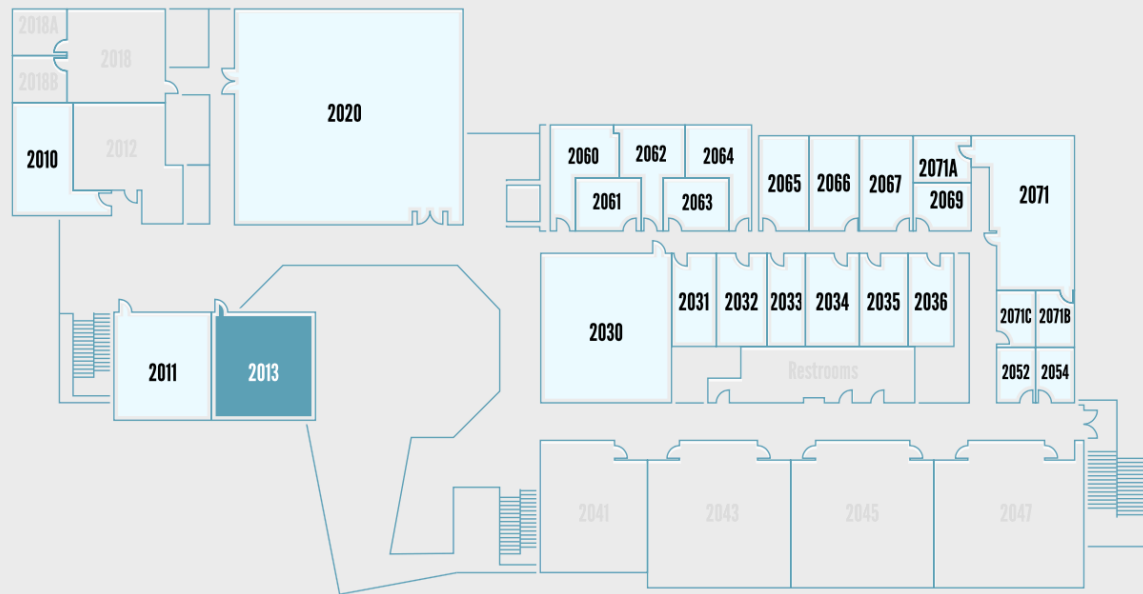

VALLEY 2013 (22)

- Video projector/flat screen display
- Laptop input
- Wi-Fi
- Whiteboard
- Mediasite Recorder

5 – Bayesian spatial modeling of veterinary data with CARBayes and Nimble (2 day)

WK6

- Friday & Saturday (Oct 11-12th)
- Room 2011

6 – Spatial Infectious Network Modeling using R and NetLogo (2 day)

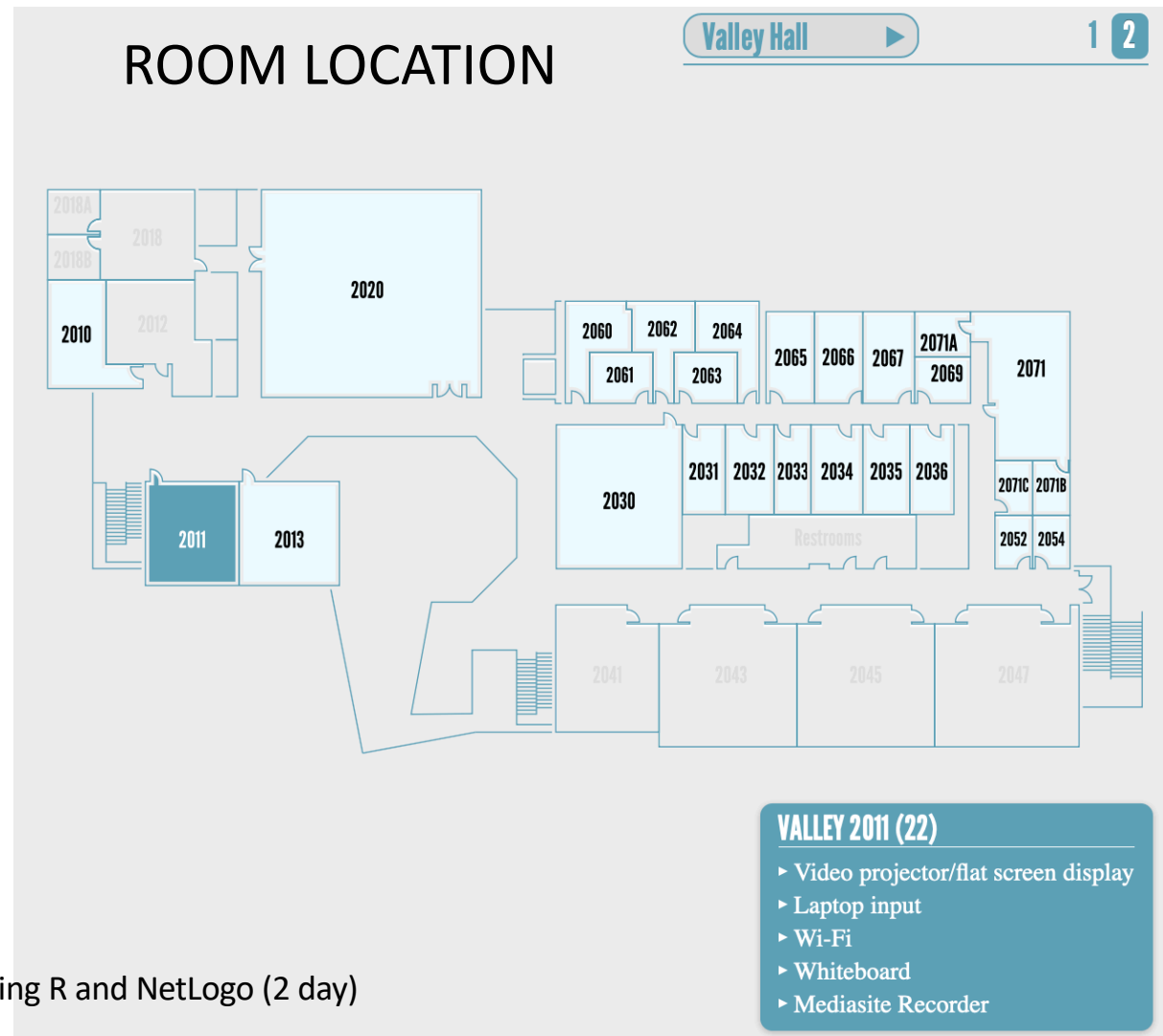

WK7

- Friday & Saturday (Oct 11-12th)
- Room 2052

ROOM LOCATION

Valley Hall

1 2

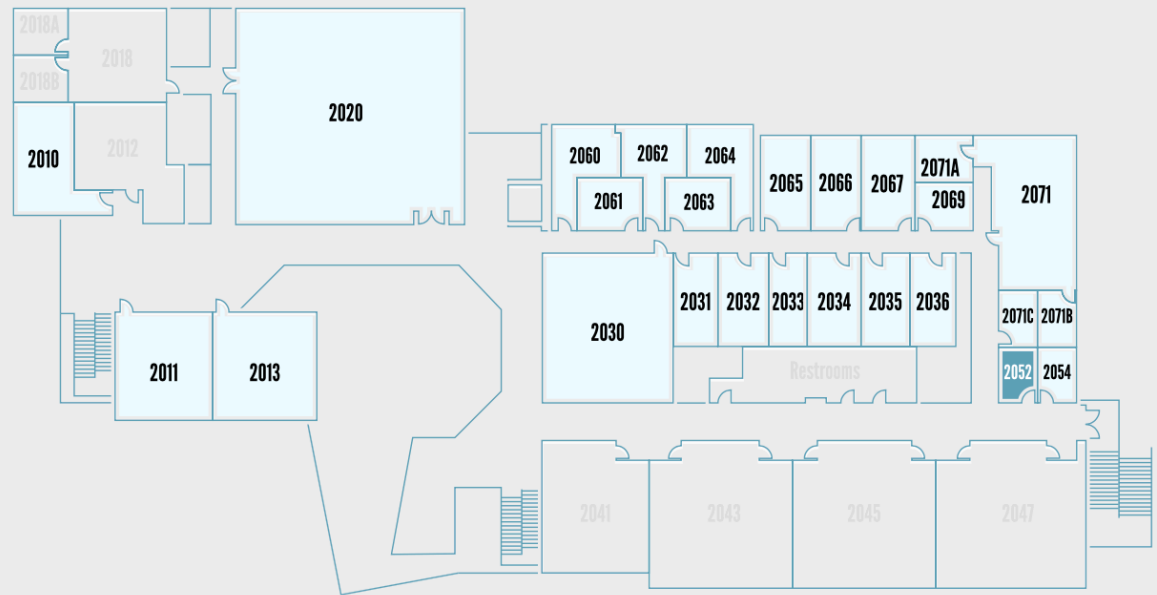

VALLEY 2052 (10)

- Video projector/flat screen display
- Laptop input
- Wi-Fi
- Whiteboard

7 – Explaining spatial point patterns in animal health: An introduction to modelling point data (2 day)

WK8

- Friday (October 11th)
- Room 1011

8 – Spatial Distribution Modeling with R (1 day)

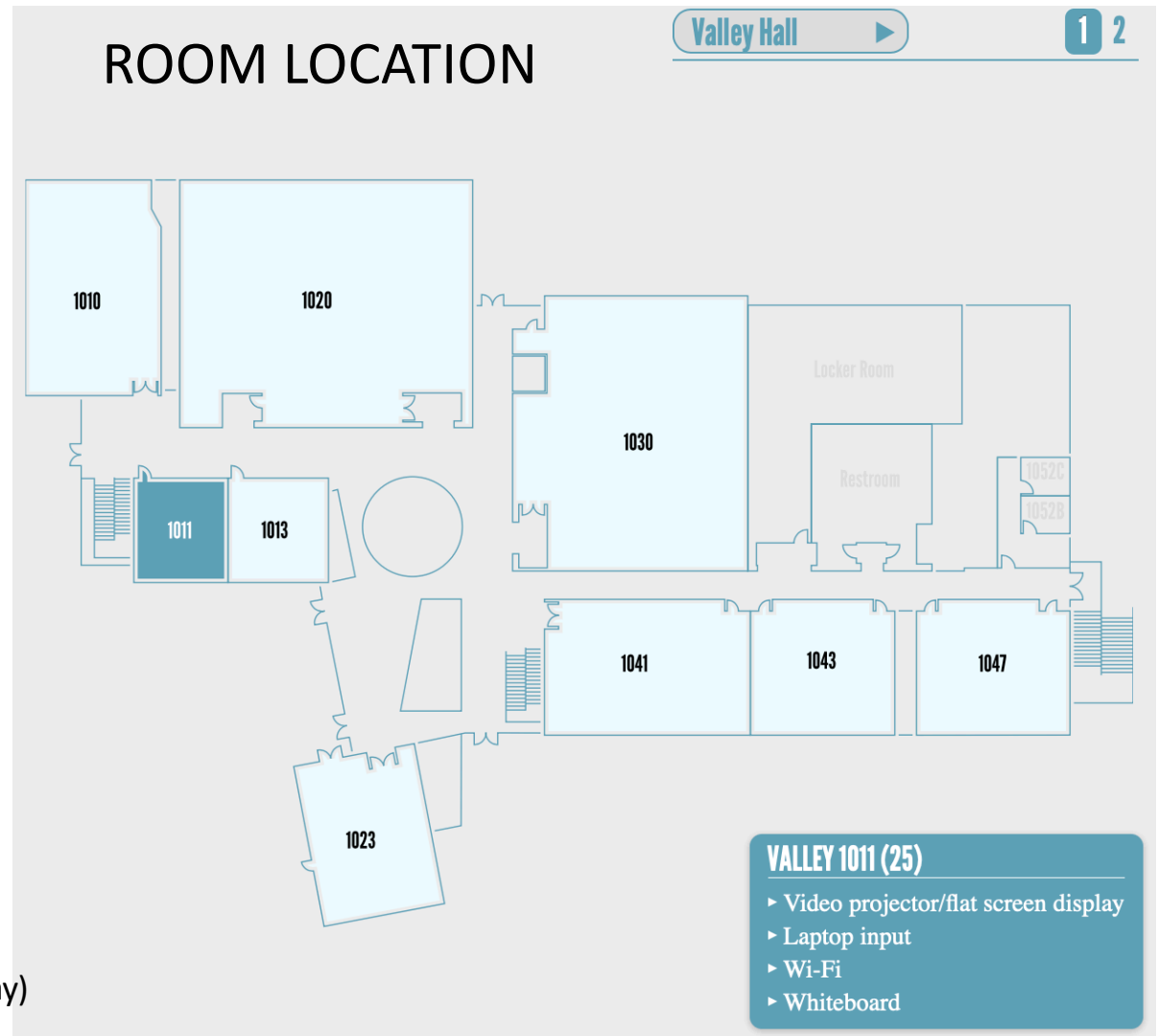

WK9

- Friday (October 11th)
- Room 2054

ROOM LOCATION

Valley Hall

1 2

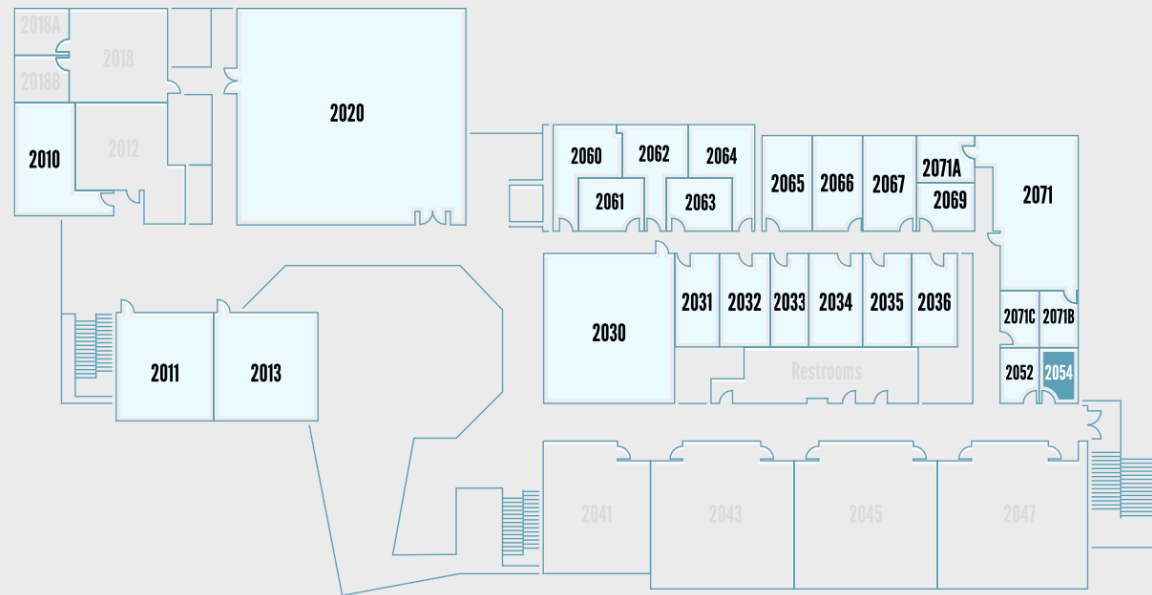

VALLEY 2054 (10)

- Video projector/flat screen display
- Laptop input
- Wi-Fi
- Whiteboard

Coffee breaks/lunch

Sunday (October 6th)
Friday-Saturday (Oct 11-12)

Coffee breaks will be at
10:30am and 3:00pm and
lunch at 12pm

Room 1023

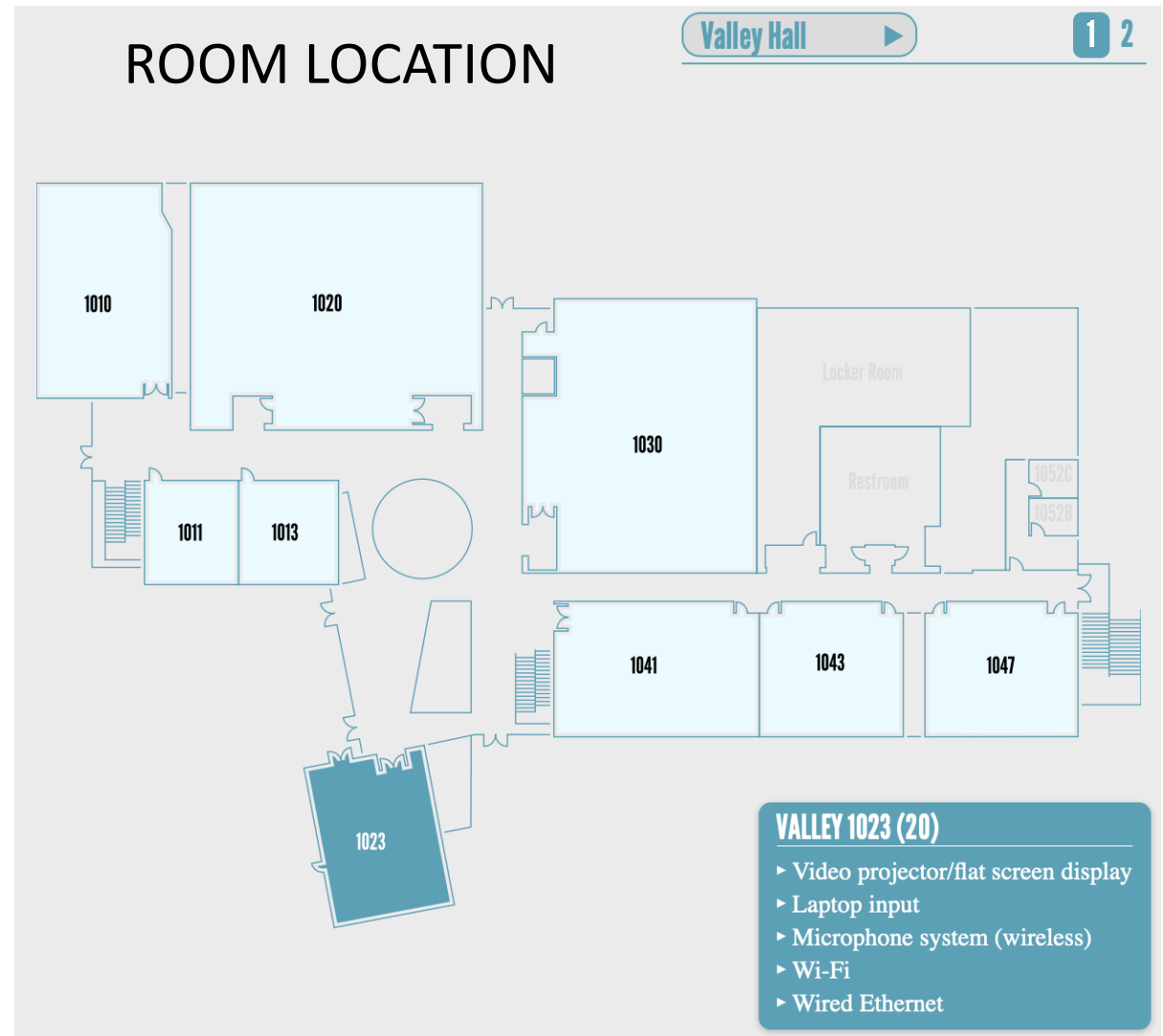

Coffee breaks/lunch

Monday Oct 7th

Coffee breaks will
be at 10:30am and
3:00pm and lunch
at 12pm

Room 2069

